



USER'S MANUAL



1080P
Full HD



Weather
Resistant



Two-Way
Audio



Motion
detection notification



2.4G
Wifi



PIR Motion
Detection



Night
Vision



110° Wide-angle
Camera Lens



Long
Battery Life



Equipped with
sound and light
expulsion alarm

Product Features

- Equipped with sound and light expulsion alarm.
- Built in battery, support sustainable standby for 8 months normal use for 6 months.
- Outdoor waterproof.
- Secure 1-minute setup.
- Built in IR still visible at night.
- 110-degree field of view with 1080P. Full HD video quality.
- Get fast push notification from the zone and motion detection function.
- Two way audio.



A. Products Technical Details

After opening the package, please make sure the camera is in good condition, confirm below accessories are complete or not.

1. O1 Camera *1
2. 5v Power adapter *1
3. Screw package *1
4. Quick installation guide *1



O1(bracket including) x1

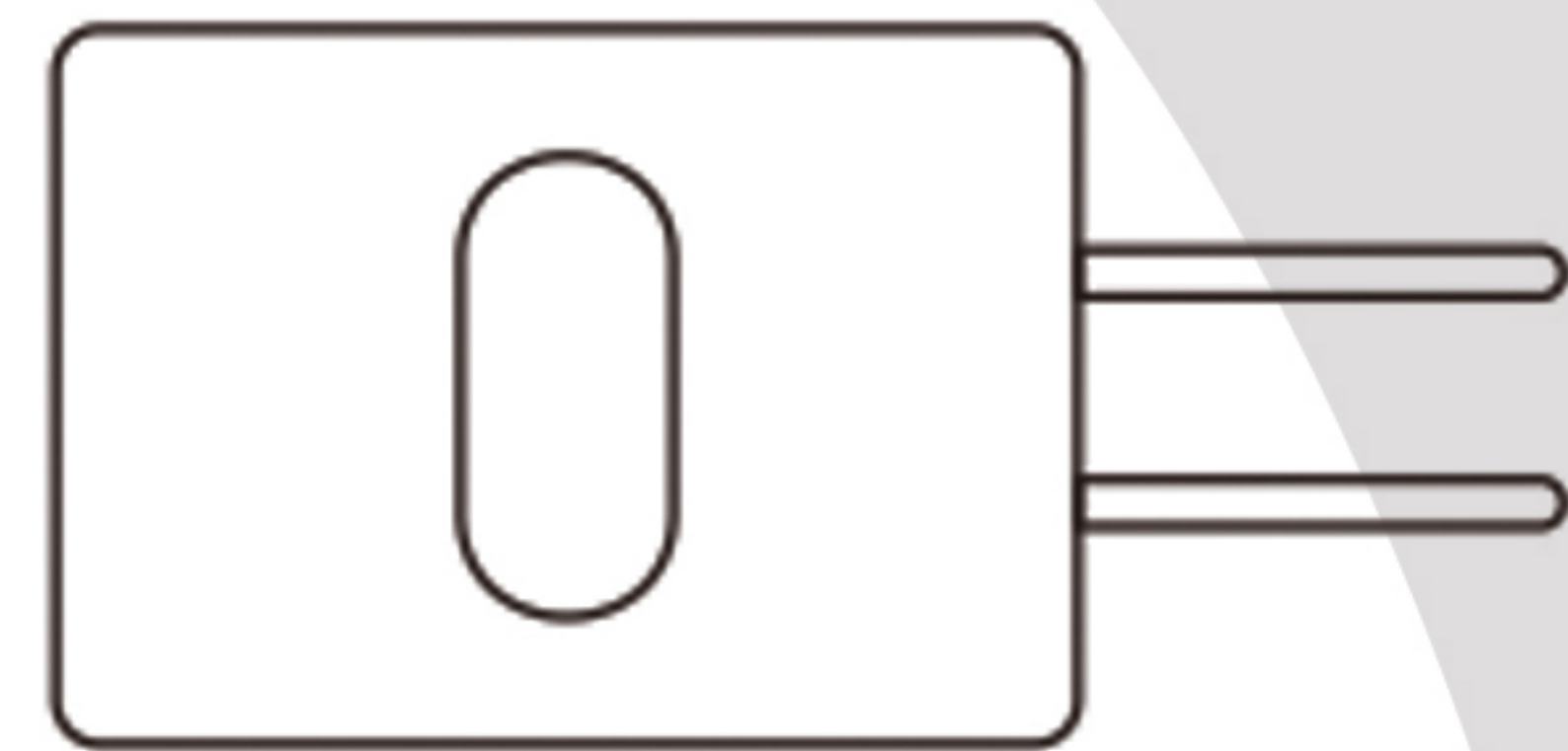

5V Power adapter x1

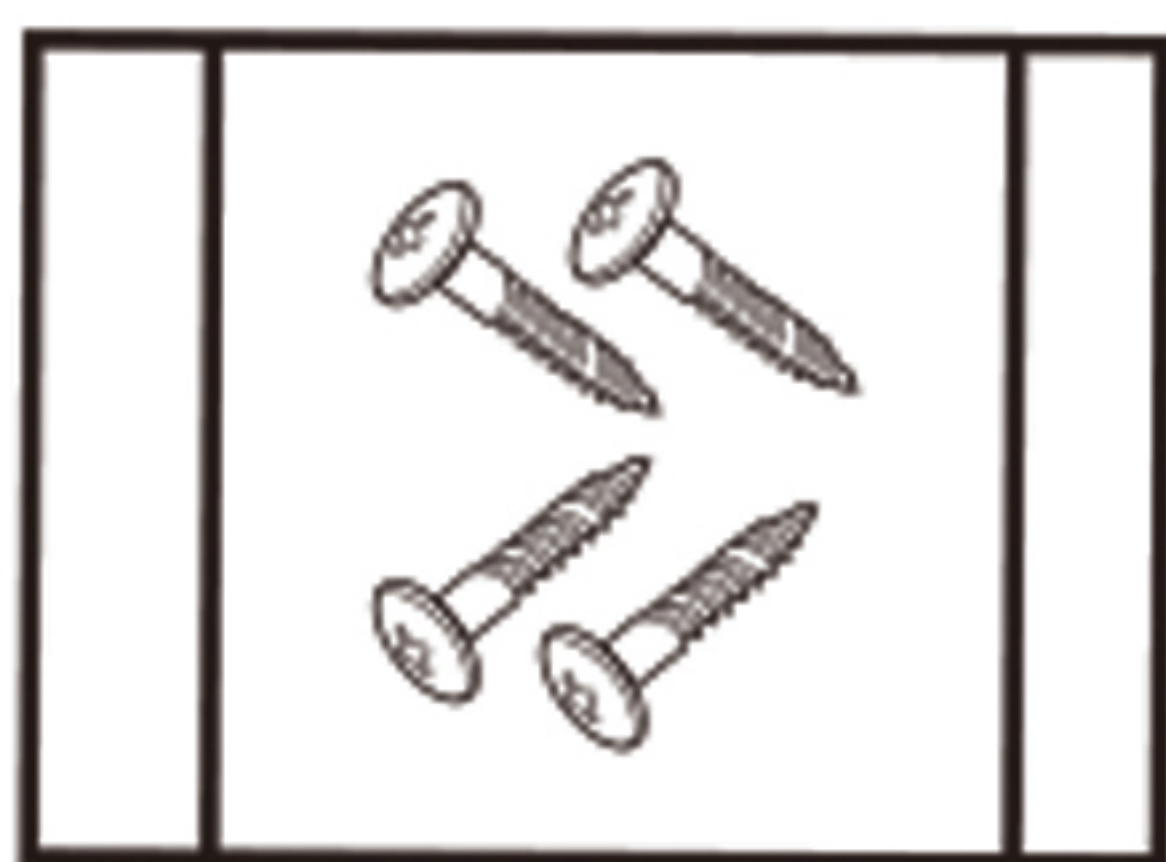

Accessories package x1



Quick start guide x1

A. Appearance Description

Switch Switch on the camera.

Reset Press the reset button for 5 seconds, until you will hear the sound "Factory Default Settings"

SD Card Support micro SD card local storage (Max support 128G), after inserting SD card please login Interfree application to format it).

Power Adapter 5V-1A.

Battery 18650

Speaker Support two way audio talks and voice prompt.

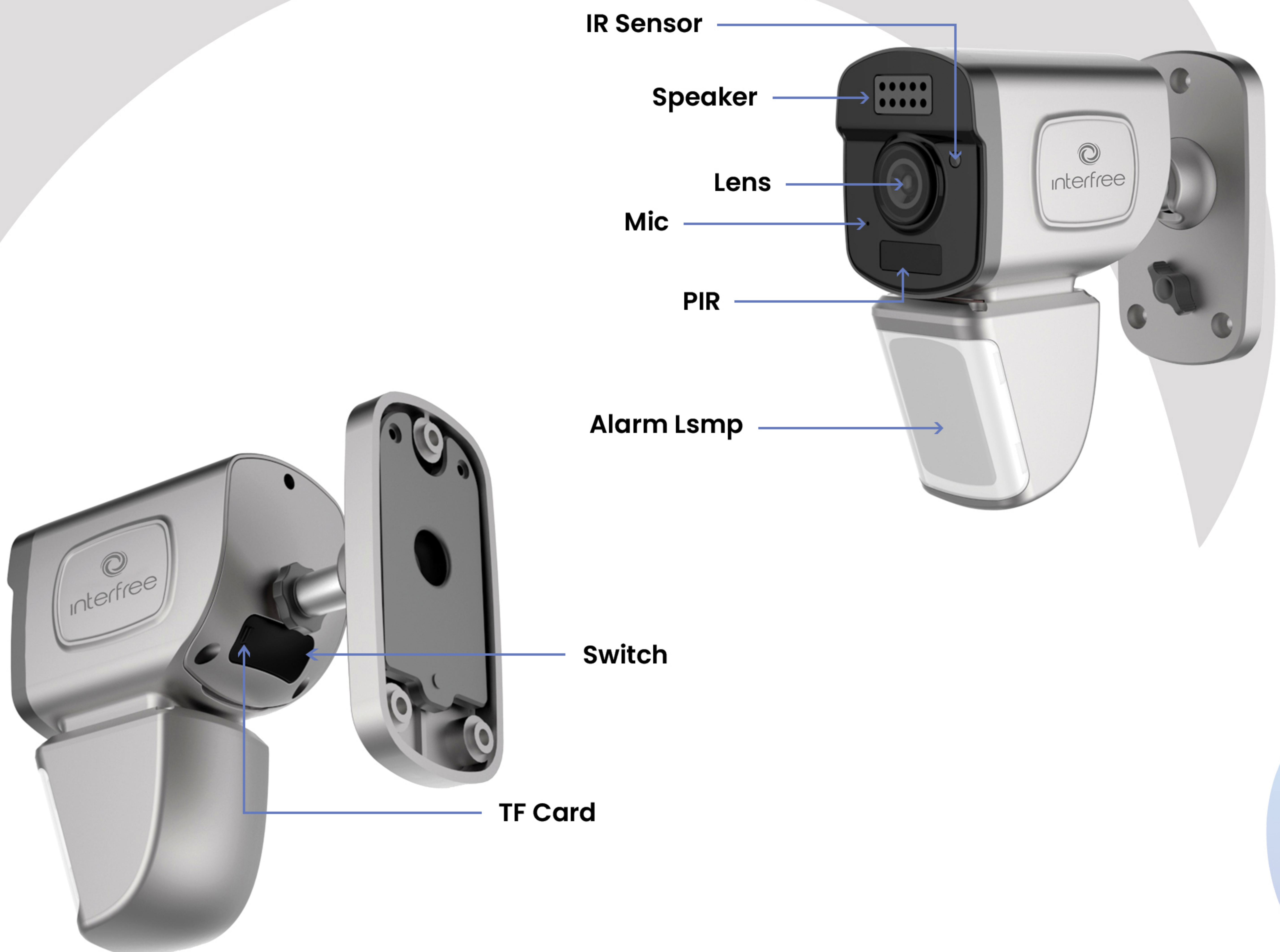



B: Download the Interfree Application

Please use your phone to scan the QR code or search "Interfree" APP in APP store or Google play.



Download Now



E: Wi-Fi Configuration

1. Enter the APP, click “+” to add new device.

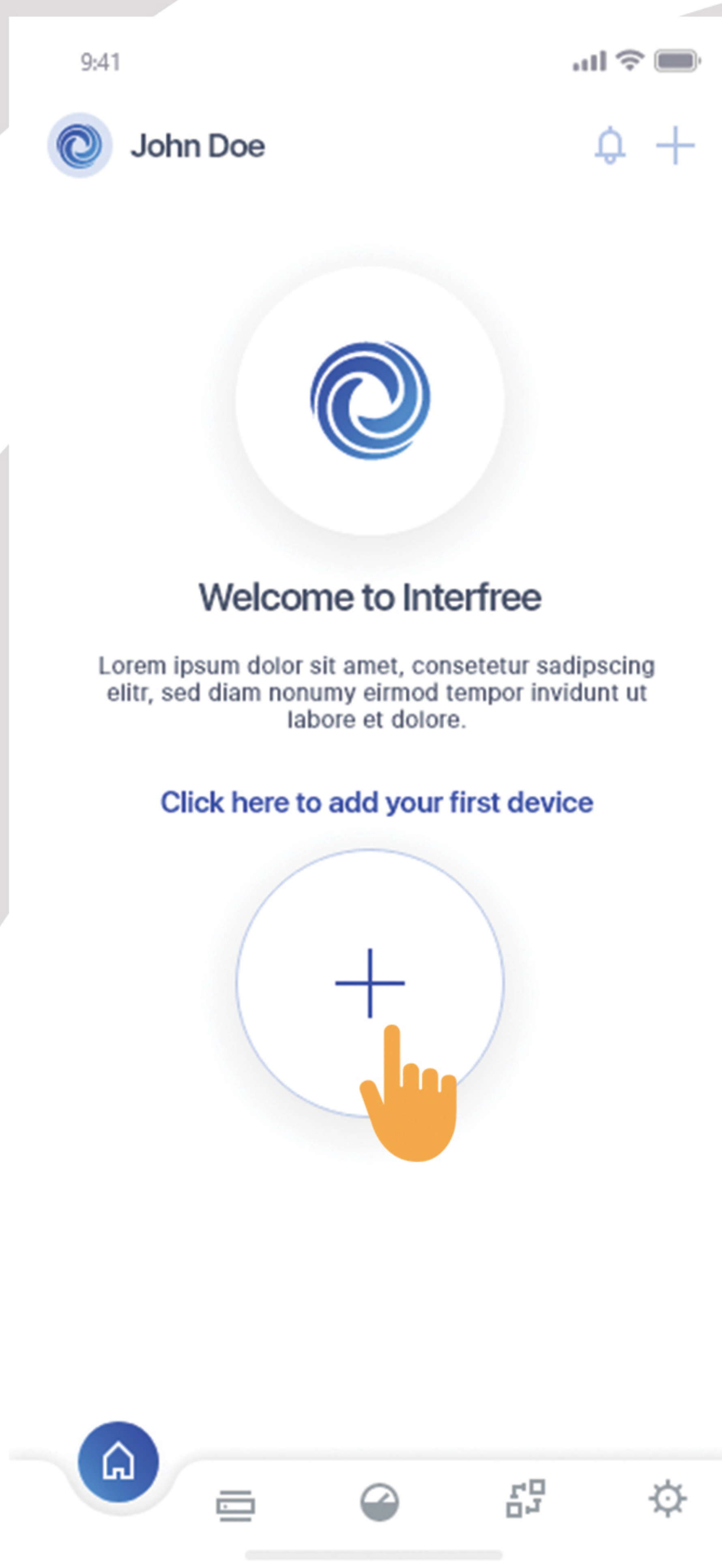

Clicking “+” icon to
Adding devices

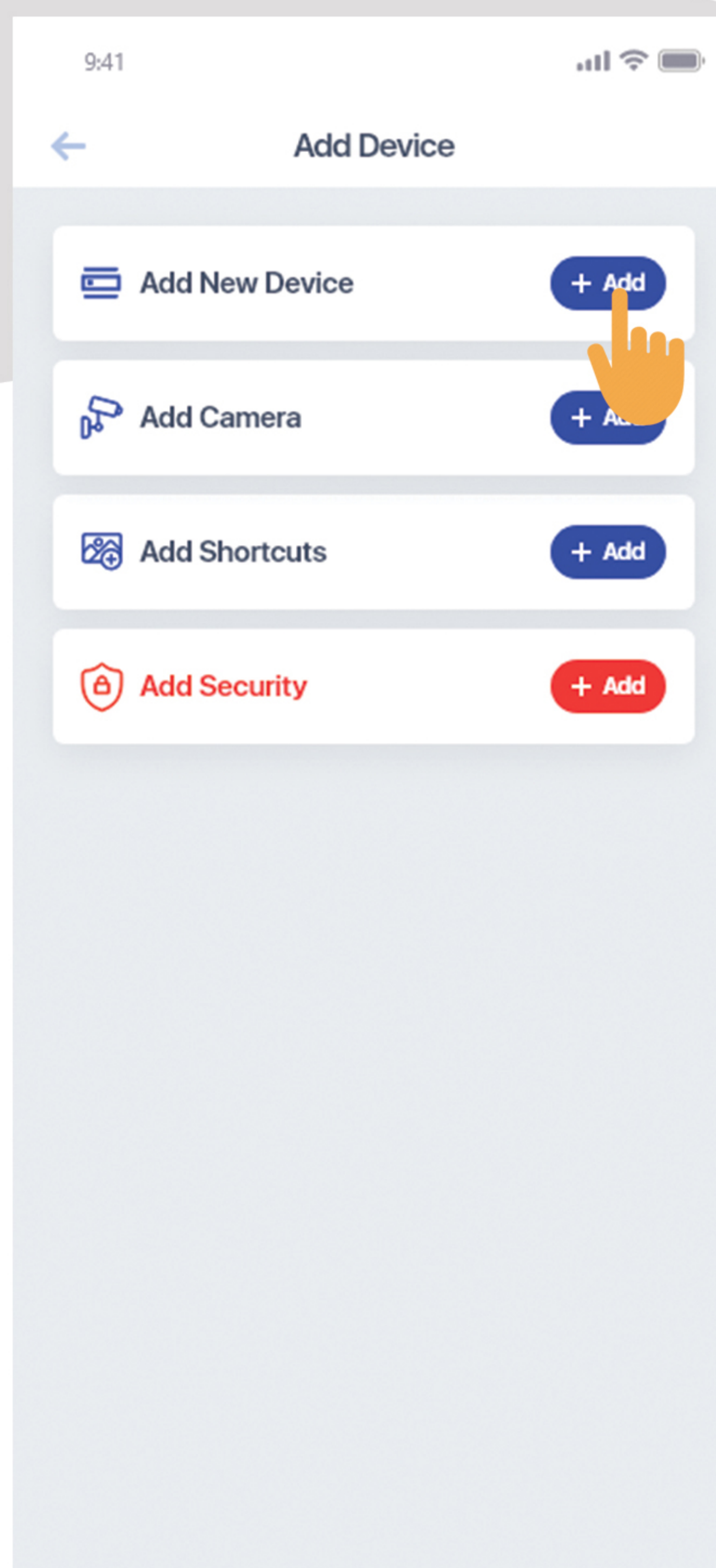

By clicking on “+add”
user able to add device

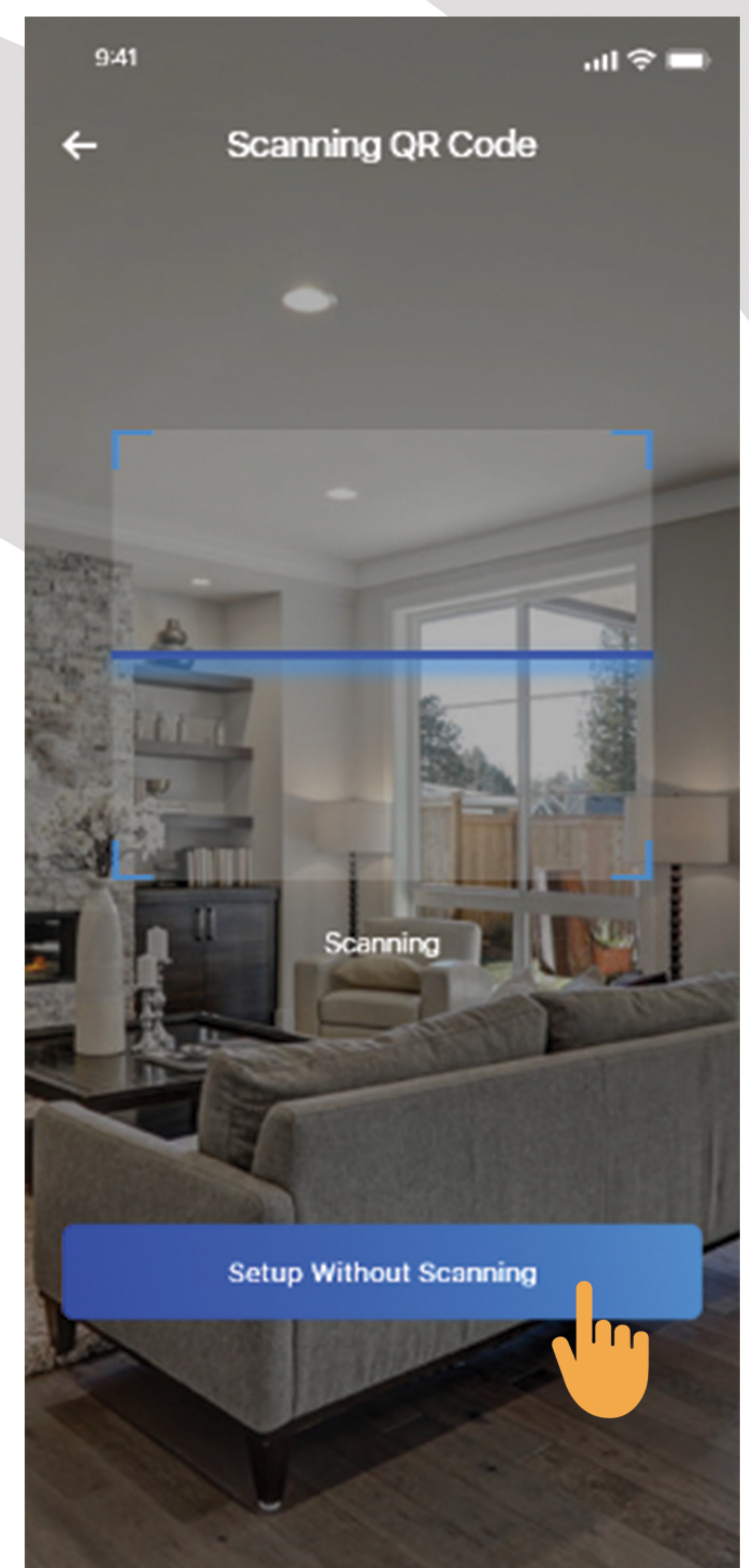

Scan the QR code
on device

Note : If the device is using first time, device will be offline, and device need to setup without scanning.

2: If device is first time using, it is offline, please confirm the device is powered on, then configure Wi-Fi network for it.

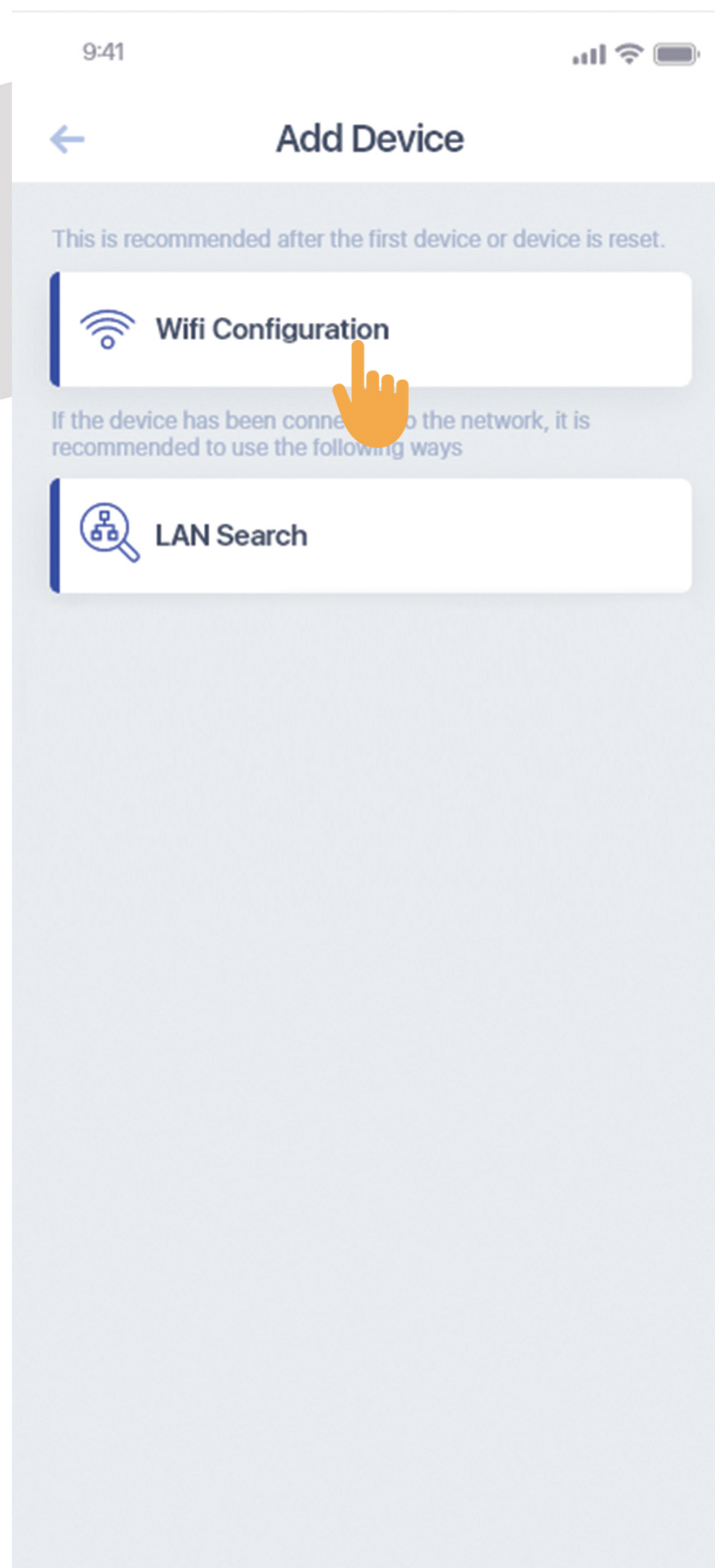

3: First click the push button then press the reset button till the reset reminder tone.

“Reset to factory settings” on, and then the device needs about 20 seconds to enter the AP mode. Hear the warning tone after 20 seconds “Waiting for the configuration” then press next.

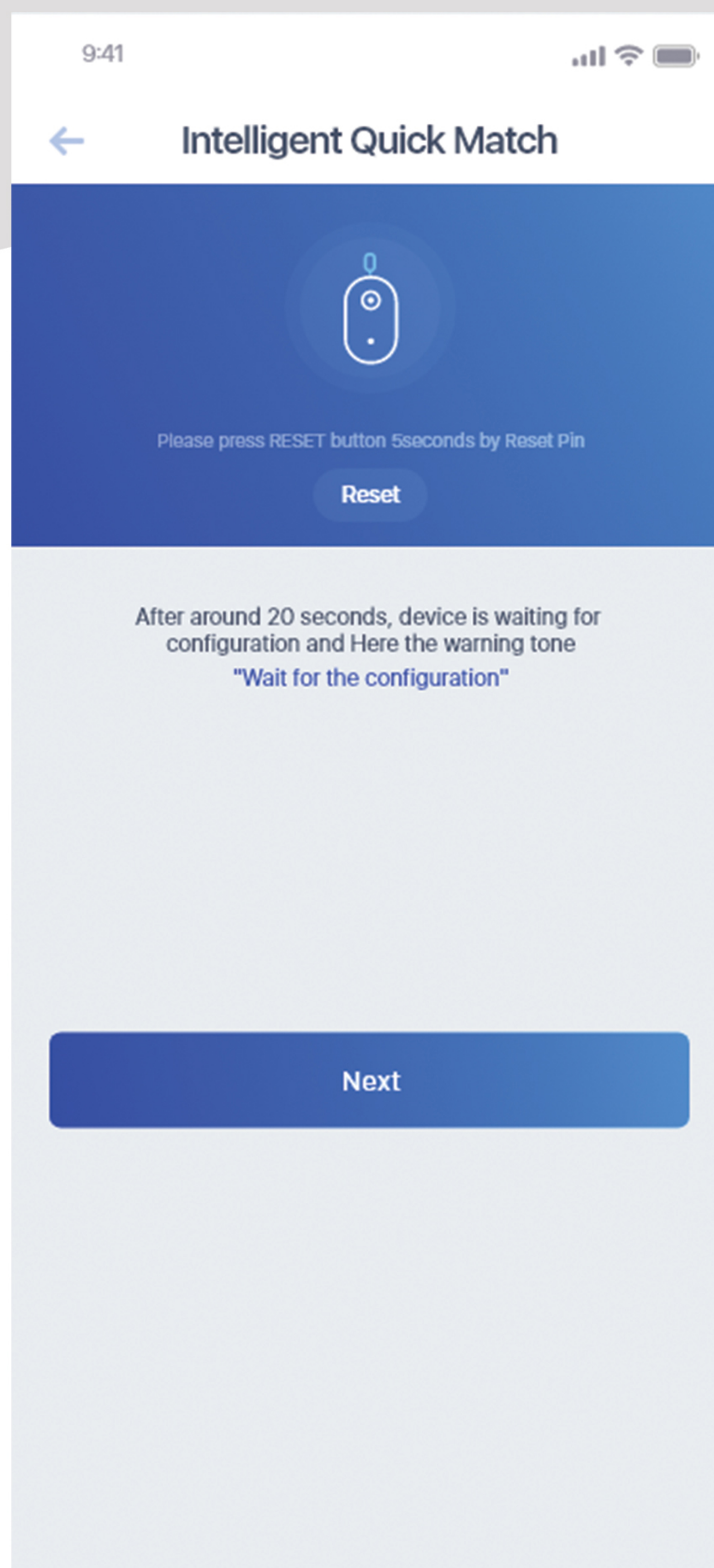

4: Choose the Wi-Fi the device will connect to, fill in the Wi-Fi password. Click to “Next”, the device will receive the configure information then begin to connect.

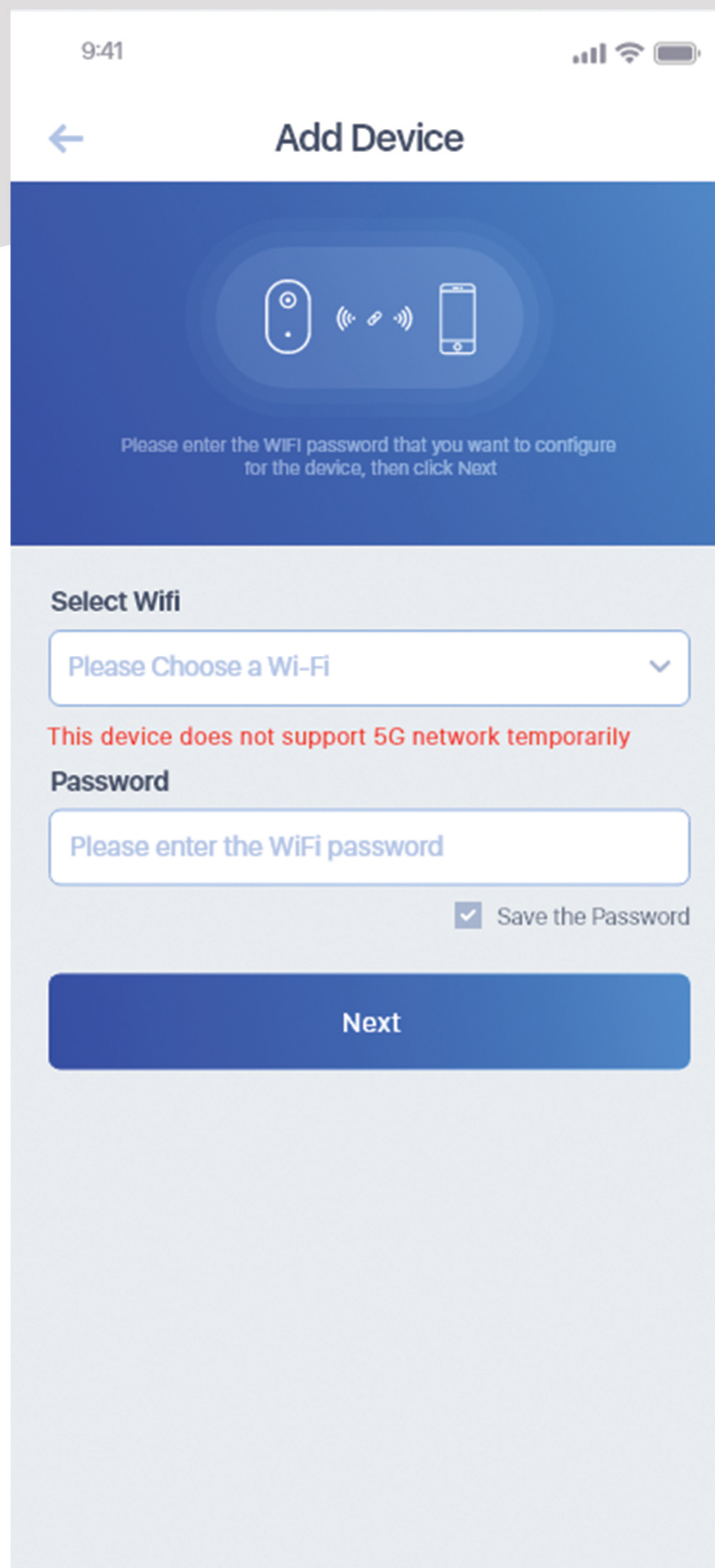

9:41

← Add Device

Please enter the WiFi password that you want to configure for the device, then click Next

Select Wifi

Please Choose a Wi-Fi

This device does not support 5G network temporarily

Password

Please enter the WiFi password

☒ Save the Password

Next

5: Keep your phone closed to the device for configuration. When the device is configured, it will notify the user.

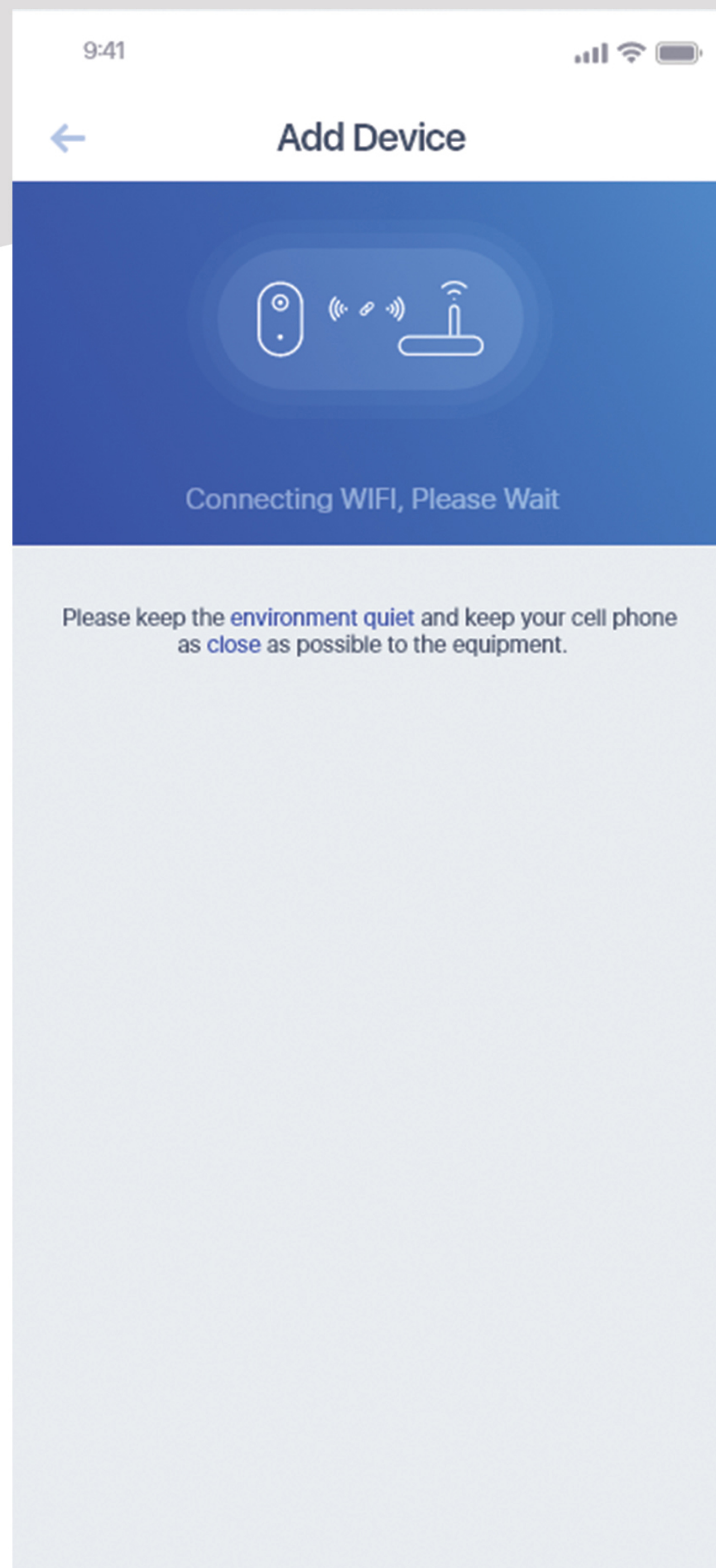

6: After the remind tone-“The connection is successful” on, the device has completed the configuration. Add device, create device name and password.

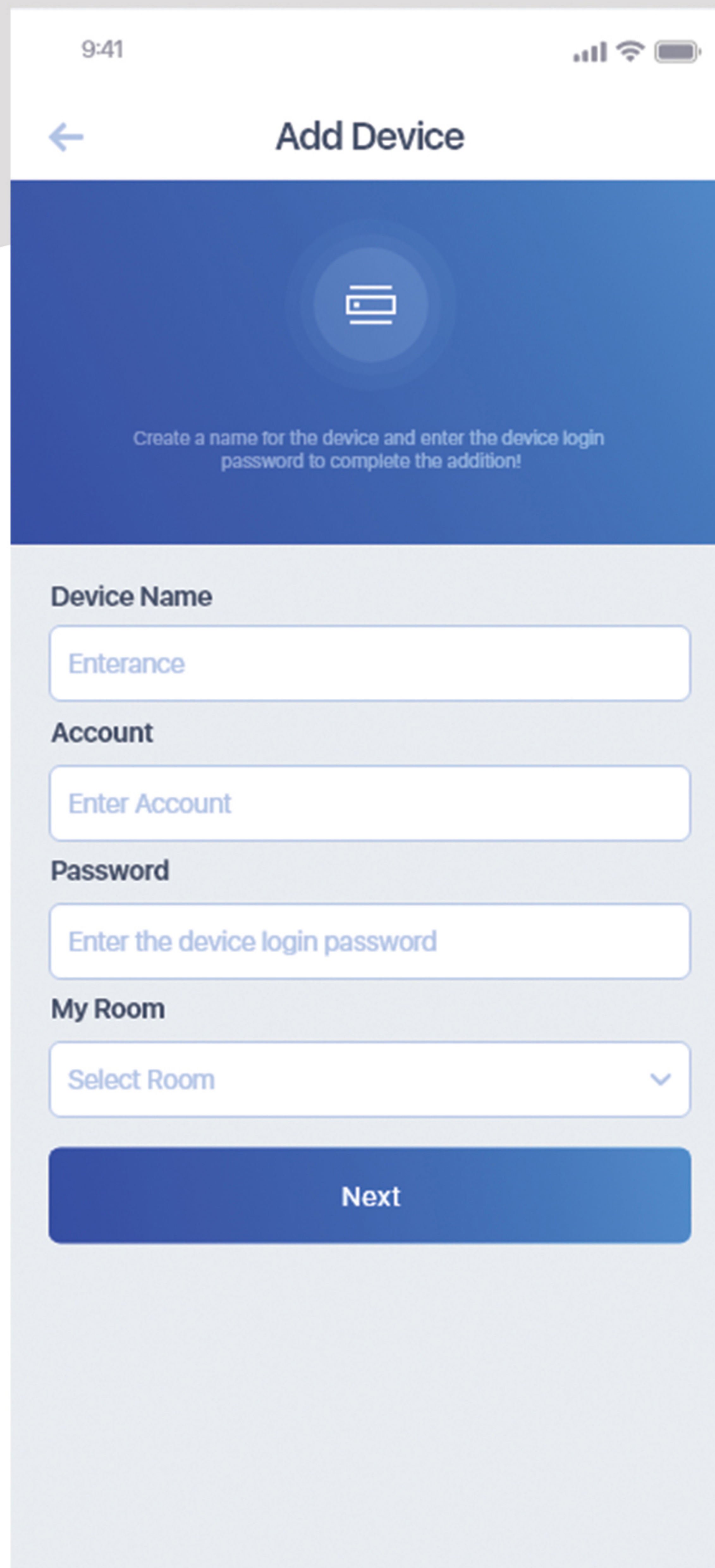

9:41

← Add Device

Create a name for the device and enter the device login password to complete the addition!

Device Name

Entrance

Account

Enter Account

Password

Enter the device login password

My Room

Select Room

Next

7: Access the device from your mobile phone.

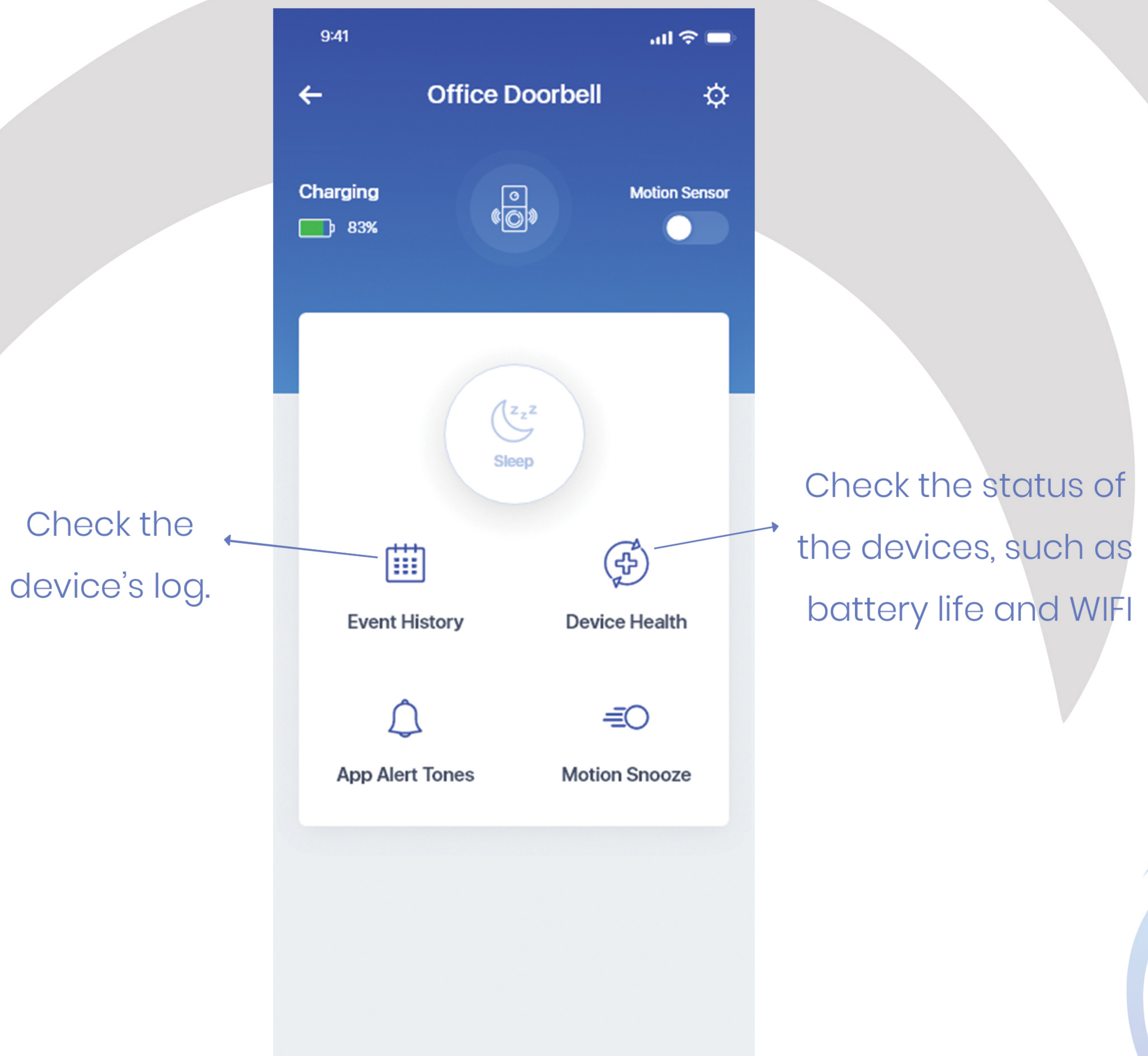

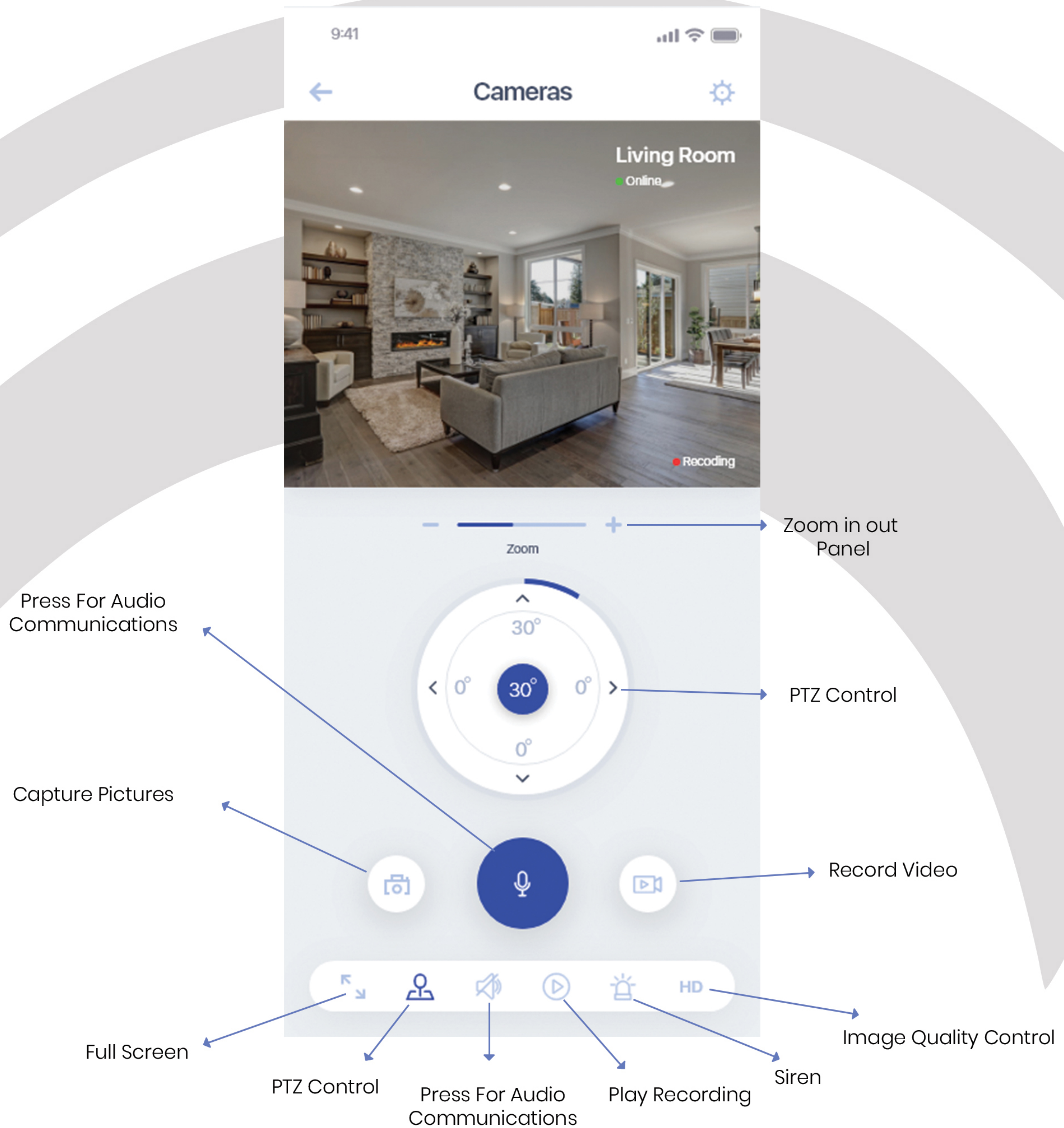

Installation

1. Install the bracket(optional)

Screws fix's on the wall put the bracket on screw cap, finish the bracket installation.

2. Install the camera

Put the camera onto the fixed bracket, as shown in the figure below.

3. Installation finished

You can adjust the camera viewing angle freely

