

smanos®

MULTILINGUAL

USER MANUAL



smanos®

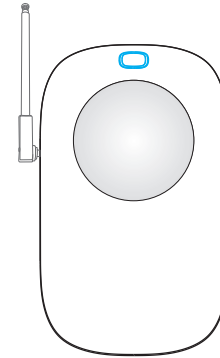

SR1000

Plug-in Wireless Signal Repeater

Introduction

The repeater is a wireless signal relay transmission device. With MCU technology, it can decode the signal in the air and strengthen the transmitting power to extend the transmission distance range. Failure to receive signal to panel from wireless accessories is frequently happened due to the long distance range when the remote controlling or wireless alarm systems are applied to large scale of commercial tall buildings, villa, and industrial areas. This wireless signal repeater could solve this problem and further distance range signal transmitting could be achieved.

Product Overview

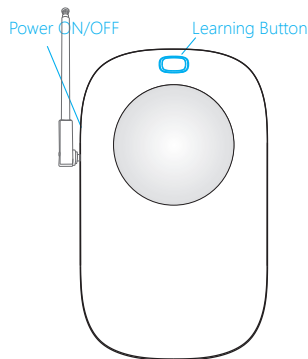

LED Indication

Green LED on: working status
Blue LED flashes once: signal transmitting
Green and blue LEDs flash alternately: in connect status

Adding and Deleting Accessories

Before adding and deleting accessories, make sure SR1000 repeater has been activated to 'connect status'. To activate connect status, you need to turn 'power' button to 'ON'; if it is already in 'ON' mode, reboot the repeater from 'OFF' to 'ON'. Indicator light will then alternately flash between green and blue. Choose following options to add or delete accessories:

Extend Transmission Distance between Accessories and Control Panel

First, press the 'Learning Button' upon the repeater, you will hear a short beep. After that, you can trigger any accessory you wish to pair to the repeater, for example, separates two components of door/window contact; if the repeater is successfully paired, a two-second length "beep" will sound with blue light on, and light will alternately shining between blue and green. You may add more accessories by repeating the steps above.

Note: If the repeater does not receive any signal within one minute, the pairing process will be canceled, it would sound beep twice meanwhile. If the repeater exits the connect status, switch off and then switch on the repeater to re-enter the connect status. Then repeat the above operation to add more accessories.

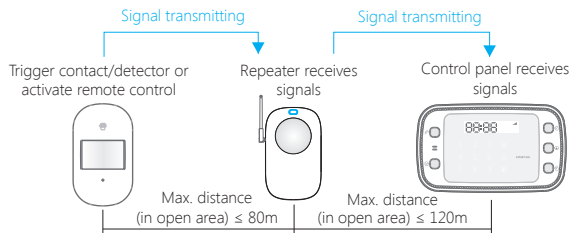
Workflow:**Extend Transmission Distance between Control Panel and Siren**

First, press the 'Learning Button' upon the repeater, you will hear a short beep. After that, press SOS button or 'Arm' the control panel; if it is successfully paired, a two-second length 'beep' will sound with blue light on, and light will alternately shining between blue and green. Transmission distance between control panel and siren is therefore extended.

If the repeater does not receive any signal within 1 minute, the pairing process will be canceled, it would sound beep twice meanwhile.

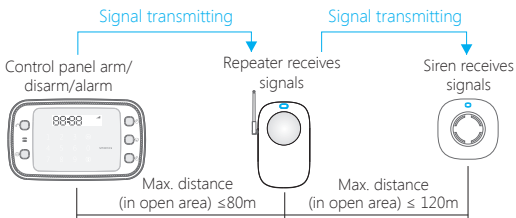
Workflow:**Deleting Accessories**

To remove all paired accessories, you only need to press and hold 'Learning Button' upon the repeater for five seconds; indicator light would turn blue, wait two seconds until the light turns green with three times beeps, then you would successfully remove all accessories.

Specifications

Power Supply: AC 110V-240V, 50/60Hz

Wireless Transmitting Range: < 150m

Wireless Receiving Range: < 80m

Radio Frequency: 915MHz (±75KHz)

Static Current: < 20.5mA

Transmitting Current: < 330mA

Maximum Accessories Supportable: 40 PCS

Back-up Battery: 3.7V 600mAh Lithium Battery, 2.22Wh

Housing Material: ABS plastic

Operating Condition:

Temperature: 0°C ~ +55°C

Relative Humidity: < 80% (non-condensing)

Dimension (L x W x H): 140 x 86 x 87mm

FCC STATEMENT

1.This device complies with Part 15 of the FCC Rules. Operation is subject to the following two conditions:

(1)This device may not cause harmful interference.

(2)This device must accept any interference received, including interference that may cause undesired operation.

2. Changes or modifications not expressly approved by the party responsible for compliance could void the user's authority to operate the equipment.

NOTE: This equipment has been tested and found to comply with the limits for a Class B digital device, pursuant to Part 15 of the FCC Rules. These limits are designed to provide reasonable protection against harmful interference in a residential installation.

This equipment generates uses and can radiate radio frequency energy and, if not installed and used in accordance with the instructions, may cause harmful interference to radio communications. However, there is no guarantee that interference will not occur in a particular installation. If this equipment does cause harmful interference to radio or television reception, which can be determined by turning the equipment off and on, the user is encouraged to try to correct the interference by one or more of the following measures:

Reorient or relocate the receiving antenna.

Increase the separation between the equipment and receiver.

Connect the equipment into an outlet on a circuit different from that to which the receiver is connected.

Consult the dealer or an experienced radio/TV technician for help.

FCC Radiation Exposure Statement:

This equipment complies with FCC radiation exposure limits set forth for an uncontrolled environment. In order to avoid the possibility of exceeding the FCC radio frequency exposure limits, Human proximity to the antenna shall not be less than 20cm(8 inches) during normal operation.